

The Queens at Selborne

This drawing is copyright and is not to be reproduced. The contractor will be held responsible for the accuracy of works involving the setting out and checking of all dimensions on the drawing and on site. Dimensions must not be scaled from this drawing.

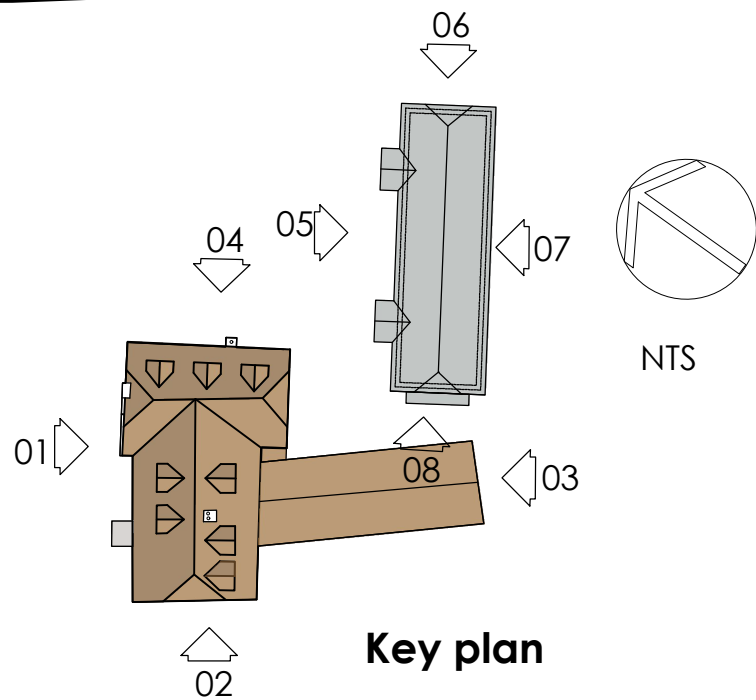

02 South West Elevation



Key plan

Planning

Rev f - 24/08/2021 - entrance width to front carpark reduced, trees added behind wall, parking space size increased
 Rev e - 27/04/2021 - low screening wall added to existing front carpark
 Rev d - 15/12/2020 - side extension removed, single storey retained, new single storey block added to rear
 rev c - flat roof replaced with dormer, transom added to windows
 15.05.20 b - extension revised
 31.07.18 A - CLADDING REMOVED FROM ENTRANCE
 REVISIONS:

barclay+phillips
architects

a: The Studio, 5 Oakridge Office Park,
Southampton Road, Salisbury SP5 3HT
e: enquiries@barclay-phillips.co.uk
t: +44 (0) 1722 711177

www.barclay-phillips.co.uk

PROJECT:
Proposed Re-development of The Queens at Selborne, High Street,
Selborne, Hampshire, GU34 3JJ
CLIENT:
Derek Warwick Developments Ltd.

DRAWING TITLE:
Proposed South West Elevation



SCALE:
1:100 @ A3

DATE:
Mar 2018

DRAWING No.
P18-014
02-05-002f

DRAWN BY:
LA

CHECKED BY:
NB